

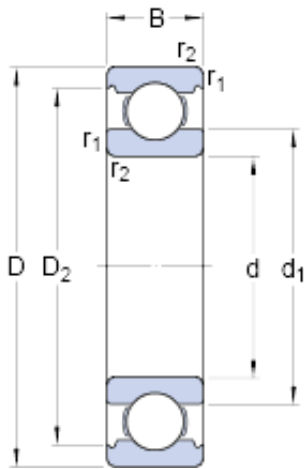

China 608 Bearing Supplier



6204 Bearing 2D drawings and 3D CAD models

High Quality SKF Ball Bearing 6204 6205 6206 Zz 2RS

Bearing No. 6204

Size	47x20x14 mm
Bore Diameter	47 mm
Outer Diameter	20 mm
Width	14 mm
d	20 mm
D	47 mm
B	14 mm
d ₁	28.8 mm
D ₂	40.59 mm
r _{1,2} - min.	1 mm
d _a - min.	25.6 mm
D _a - max.	41.4 mm
r _a - max.	1 mm
Basic dynamic load rating - C	13.5 kN
Basic static load rating - C ₀	6.6 kN
Fatigue load limit - P _u	0.28 kN
Reference speed	32000 r/min
Limiting speed	20000 r/min
Calculation factor - k _r	0.025
Calculation factor - f ₀	13
Category	Single Row Ball Bearings
Inventory	0.0
Manufacturer Name	SKF
Minimum Buy Quantity	N/A



China 608 Bearing Supplier

Weight / Kilogram	0.109
EAN	7316577061645
Product Group	B00308
Enclosure	Open
Precision Class	ABEC 1 ISO P0
Maximum Capacity / Filling Slot	No
Rolling Element	Ball Bearing
Snap Ring	No
Internal Special Features	No
Cage Material	Steel
Internal Clearance	C0-Medium
Inch - Metric	Metric
Long Description	20MM Bore; 47MM Outside Diameter; 14MM Outer Race Diameter; Open; Ball Bearing; ABEC 1 ISO P0; No Filling Slot; No Snap Ring; No Internal Special Features
Category	Single Row Ball Bearing
UNSPSC	31171504
Harmonized Tariff Code	8482.10.50.68
Noun	Bearing
Keyword String	Ball
Manufacturer URL	http://www.skf.com
Manufacturer Item Number	6204
Weight / LBS	0.24
Outside Diameter	1.85 Inch 47 Millimeter
Outer Race Width	0.551 Inch 14 Millimeter
Bore	0.787 Inch 20 Millimeter
d ₁	28.8 mm
D ₂	40.59 mm
r _{1,2} min.	1 mm



China 608 Bearing Supplier

d_a min.	25.6 mm
D_a max.	41.4 mm
r_a max.	1 mm
Basic dynamic load rating C	13.5 kN
Basic static load rating C_0	6.55 kN
Fatigue load limit P_u	0.28 kN
Calculation factor k_r	0.025
Calculation factor f_0	13
Mass bearing	0.1 kg